

Sold

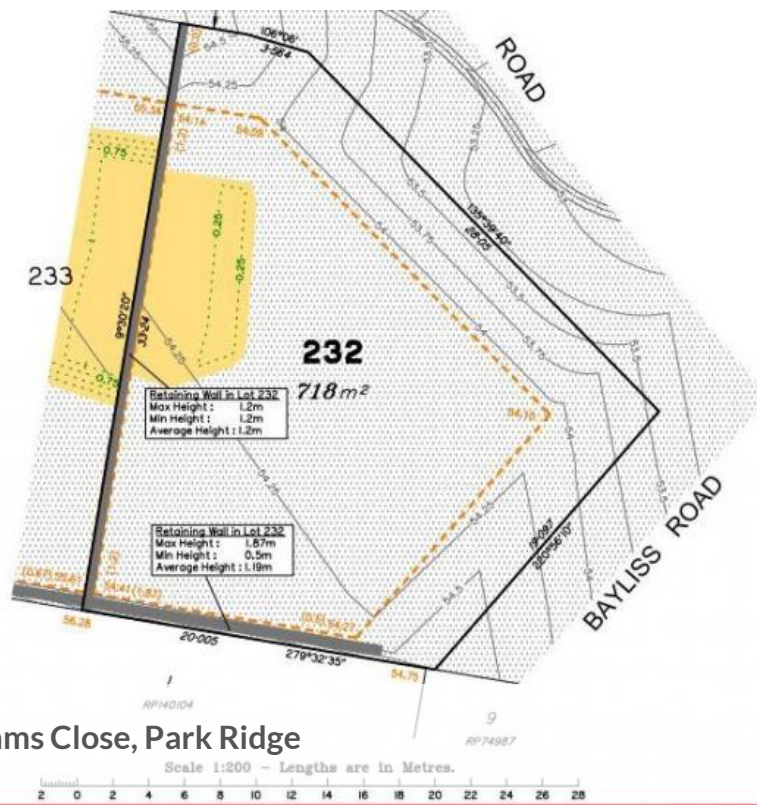

<p>--- Depth of Fill Contours</p> <p>--- Proposed Earthworks Pad</p> <p>30.75 Finished Earthworks Design Level</p> <p>Retaining Wall (Height shown on lower side of wall)</p> <p>(Not all items in this legend may be relevant to the lot shown hereon)</p>	<p>NOTES</p> <p>This plan has been prepared from preliminary survey plan (SP302887), engineering plans provided on the 02/02/2016 by Wilkinson Shaw & Associates.</p> <p>Development approval has been received for this subdivision (RL/129/2015/B) from the Logan City Council (05/10/2017).</p> <p>Development Approval has not been granted for Operational Works for the proposed lot.</p> <p>All fill shall be placed and compacted in a controlled manner so that Level 1 level of responsibility may be achieved and certified as per AS3798-2007.</p> <p>Base surface, used to determine areas and depths of cut and fill, vide detail survey: 8284 S 10 DT A, undertaken by Saunders Havill Group dated 21/11/2017. No allowance has been made for earthworks undertaken prior to this survey.</p> <p>Base surface, used to determine areas and depths of cut and fill, vide detail survey: 8284 S 10 DT A, undertaken by Saunders Havill Group dated 21/11/2017. No allowance has been made for earthworks undertaken prior to this survey.</p>
---	---

LOT 232-23 Williams Close, Park Ridge

LARGE BLOCK OF LAND FOR SALE 718M2 SOLD

Land for sale at 23 Williams close off Waller Road, Park Ridge 4125 QLD

Just very few blocks available, Take action now as this won't last long at the end of CUL DE SUC.

Facing Waller Road

Flood free

Call Aiyub Khan on 0406427990 for private viewing

The above information provided has been furnished to us by the vendor/s. We have not verified whether or not that information is accurate and do not have any belief in one way or the other in its accuracy. We do not accept any responsibility to any person for its accuracy and do no more than pass it on. All interested parties should make and rely upon their own inquiries in order to determine whether or not this information is in fact accurate.

718 m²

Price SOLD for \$287,500

Property Type Residential

Property ID 34

Land Area 718 m²

AGENT DETAILS

Aiyub Khan - 0406 427 990

OFFICE DETAILS

Future Properties Group Pty Ltd
287 Algester Rd Algester, QLD, 4115
Australia
0406 427 990

